

GENERAL STRUCTURE

Note: All dimensions in mm unless otherwise stated

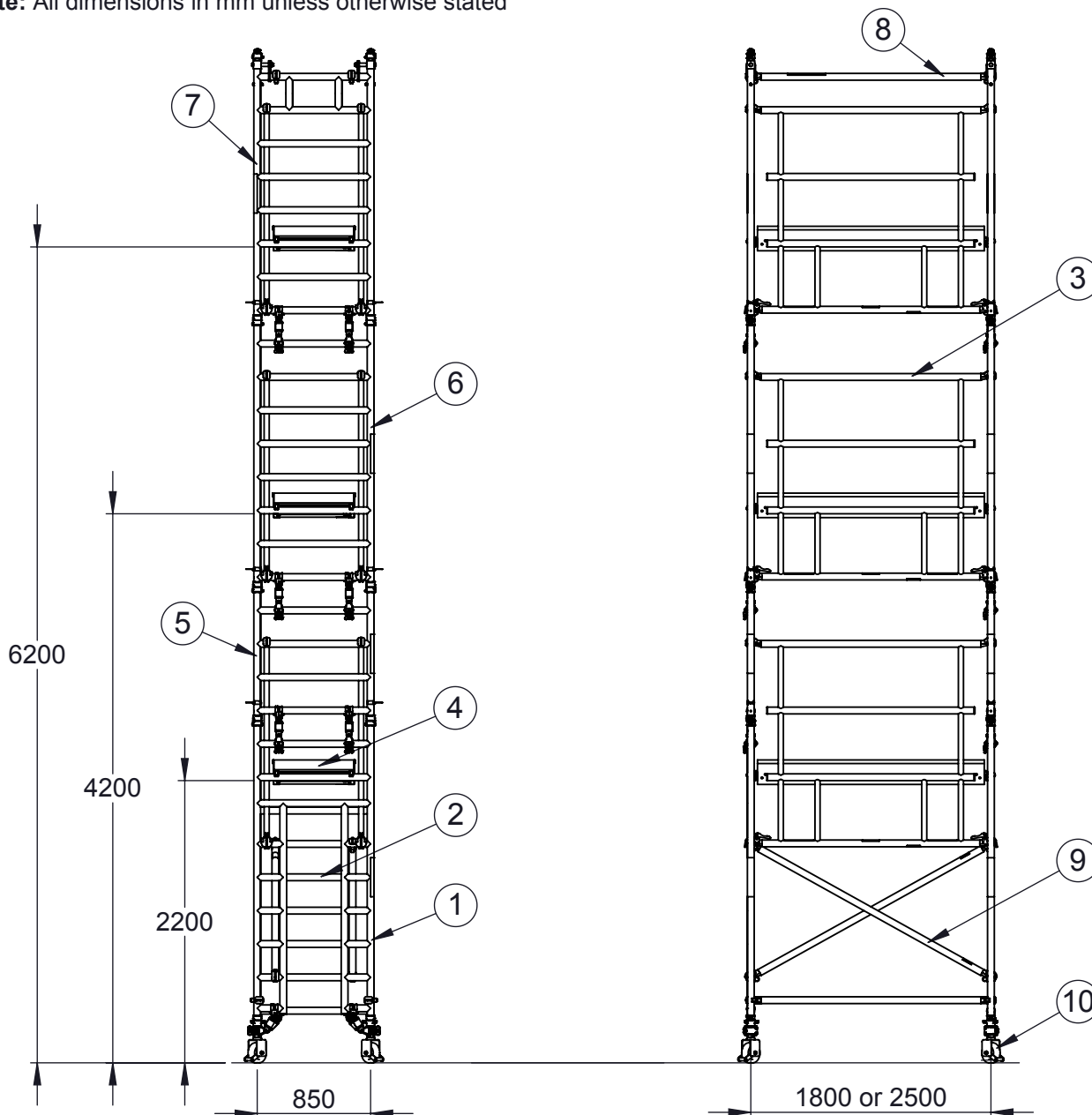

Note: Stabilisers are required but are omitted from image for clarity purposes only.

(6.2m Tower Shown)

ITEM NO.	DESCRIPTION	ALTERNATIVE LENGTH
1	WALK-THROUGH FRAME - WITH LINK BRACES - 2.25m - 9 RUNG - 850 WIDE	-
2	CLIMBING FRAME - WITH LINK BRACES - 2.25m - 9 RUNG - 850 WIDE	-
3	GUARDRAIL - MULTIGUARD - 1.8m	2.5m
4	1.8m TRAP DOOR DECK WITH FIXED TOE BOARDS	2.5m
5	CLIMBING FRAME - WITH LINK BRACES - 1.0m - 4 RUNG - 850 WIDE	-
6	CLIMBING FRAME - WITH LINK BRACES - 2.0m - 8 RUNG - 850 WIDE	-
7	LIFTING FRAME - WITH LINK BRACES - 2.0m - 8 RUNG - 850 WIDE	-
8	1.8m HORIZONTAL BRACE	2.5m
9	2.1m DIAGONAL BRACE	2.7m
10	ADJUSTABLE LEG ASSEMBLY - WITH RETAINED CASTOR	-
11	STABILISER - SP10	-

FRAME IDENTIFICATION

Note: All dimensions in mm unless otherwise stated

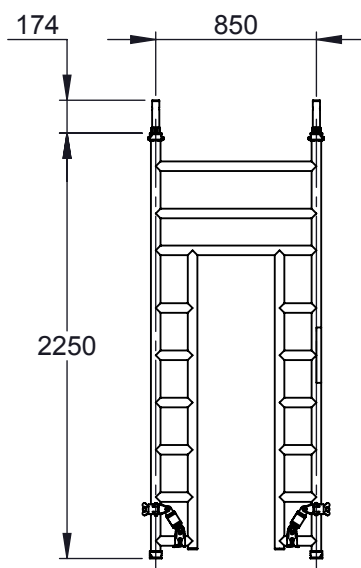

FRAME NO. 1

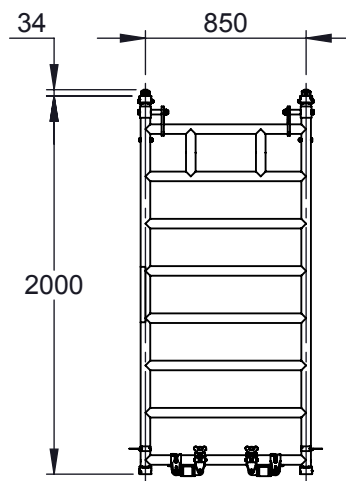

FRAME NO. 2

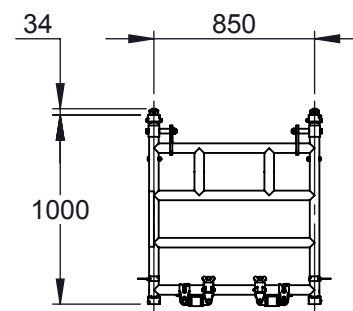

FRAME NO. 3

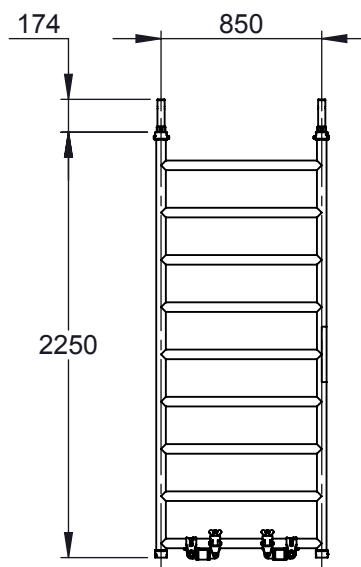

FRAME NO. 4

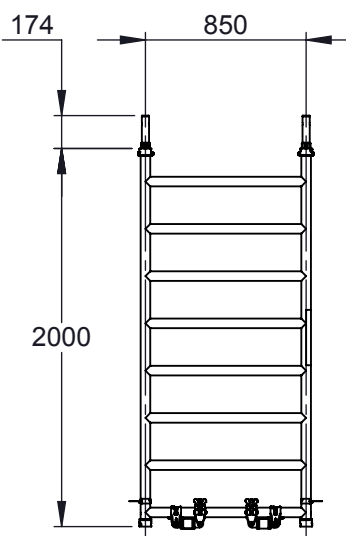

FRAME NO. 5

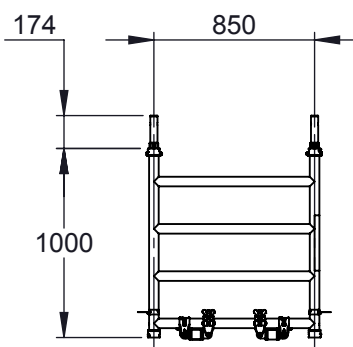

FRAME NO. 6

FRAME NO.	PART NO.	DESCRIPTION	WEIGHT
1	398528	WALK-THROUGH FRAME - WITH LINK BRACES - 2.25m - 9 RUNG - 850 WIDE	11.4kg
2	398523	LIFTING FRAME - WITH LINK BRACES - 2.0m - 8 RUNG - 850 WIDE	9.9kg
3	398530	LIFTING FRAME - WITH LINK BRACES - 1.0m - 4 RUNG - 850 WIDE	8.8kg
4	398529	CLIMBING FRAME - WITH LINK BRACES - 2.25m - 9 RUNG - 850 WIDE	11.1kg
5	398519	CLIMBING FRAME - WITH LINK BRACES - 2.0m - 8 RUNG - 850 WIDE	11.8kg
6	398521	CLIMBING FRAME - WITH LINK BRACES - 1.0m - 4 RUNG - 850 WIDE	6.9kg